



Classic TBi 411/511

Watercooled

Robust and flexible water-power cable

Technical data

MIG/MAG (GMAW) Semi-automatic welding torch TBi 411/511

Rating at 100% ED
(10 min. cycle)

- Mixed gas: 350 A (TBi 511: 450 A)
- CO₂: 400 A (TBi 511: 500 A)

Cooling method Watercooling

Wire diameter 1.0 - 1.2 mm (TBi 511: 1.0 - 1.6 mm)

Gas flow 14 l/min

Technical specification according to IEC 60974-7

Weight with 1.5 m cable 1.60 kg (TBi 511: 1.65 kg)

Connection Euro-Central connector
Other connectors (e.g. Cloos®, ESAB®) available upon request.

Torch rating will be reduced when using pulsed-arc power sources.
Special torch necks and custom lengths of the cable assembly are available upon request.

Ordering Information

TBi 411	ESW, 50° bent	133P4415_0
TBi 511	ESW, 50° bent	134P4415_0

* At the blank, please insert 3, 4 or 5 for a torch length of 3, 4 or 5 m.

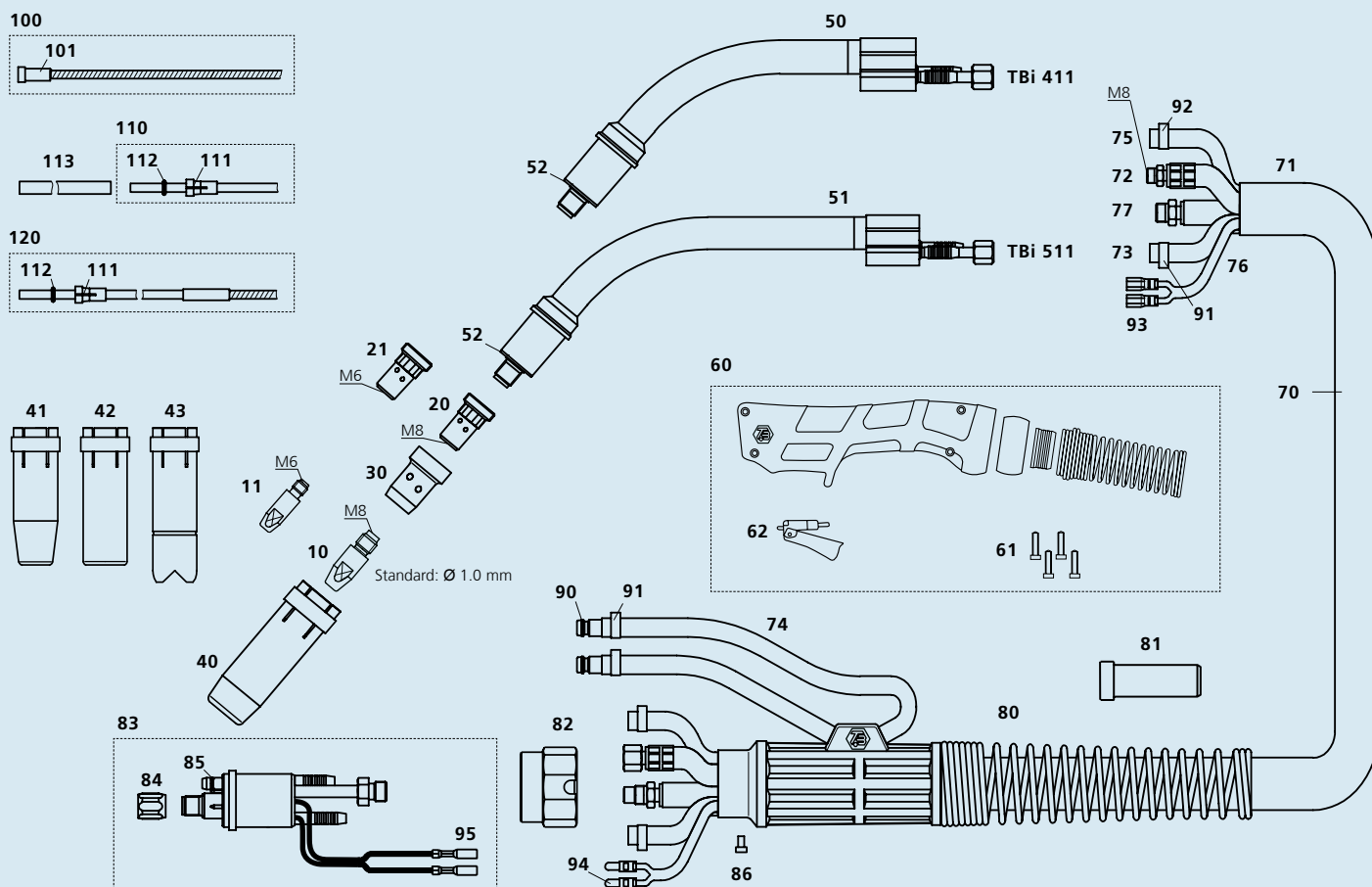

Pos. Description

Contact tips

Pos.	Description	Part. No.
▶ 10	Contact tip M8x30, Ecu	340P_1262*
10	Contact tip M8x30, CuCrZr	340P_3262*
10	Contact tip M8x30 Alu, Ecu	341P_1262*
11	Contact tip M6x28, Ecu	340P_1069*
11	Contact tip M6x28, CuCrZr	340P_3069*
11	Contact tip M6x28 Alu, Ecu	341P_1069*

Tip holders

Pos.	Description	Part. No.
▶ 20	Tip holder M8 / L=25 mm	342P008033
20	Tip holder M8 / L=29 mm	342P008133
21	Tip holder M6 / L=25 mm	342P006033
21	Tip holder M6 / L=29 mm	342P006133

Gas diffusers

Pos.	Description	Part. No.
▶ 30	Gas diffuser, white	130P002017
30	Gas diffuser, ceramic	130P002019
30	Gas diffuser, black	130P002026
30	Gas diffuser, brown	130P002031

Gas nozzles

Pos.	Description	Part. No.
▶ 40	Nozzle con. diam. 16.0 mm	345P012030
41	Nozzle con. diam. 14.0 mm	345P013030
42	Nozzle cyl. diam. 20.0 mm	345P011030
43	Spot weld nozzle diam. 20.0 mm	345P015030

Spare parts

50	Torch neck TBi 411, 50°	133P001001
51	Torch neck TBi 511, 50°	134P001001
52	Insulating washer	130P002004
60	Handle blue, watercooled, cpl. kit	380P220401
61	Cross recessed screw M 3.5x14	100P008413

▶ = Standard parts

* At the blank, please insert suitable information for torch length or wire diameter, e.g. 08 for 0.8 mm or 3 for 3 mm.

Part. No.

Pos. Description

Part. No.

62	Trigger, red, 2 poles	385P021016
70	Cable assembly 'Classic'	122P4045_0*
71	Fabric outer cover 25x1.5 mm, cpl.	307P2528_A*
72	Water power cable 'Classic'	314P1621_0*
73	PVC-Water hose, blue 5x1.5 mm	303P050000
74	PVC-Water hose, red 5x1.5 mm	303P060000
75	PVC-Gas hose, black 4.5x1.5 mm	302P010000
76	Control cable x.30 m cpl.	301P2304_0*
77	Wire conduit yellow 'Classic'	356P0401_0*
80	Cable support 3 parts cpl. with spring	701P101071
81	Cable support 70 sqmm	600P002107
82	Adaptor nut	701P001013
83	Central adaptor ESW cpl., 2 poles, moveable pins	701P001049
84	Sleeve nut M10x1	701P002005
85	O-ring 4.0x1.0 mm (gas nipple)	365P100040
86	Slotted screw M4x6	100P008401
90	Quick connector	701P002064
91	Hose clamp Ø 9.5 with ring	373P100095
92	Hose clamp Ø 8.7	371P000087
93	Cable lug, flat	375P000023
94	Insulated connector, male, round	375P000004
95	Insulated connector, female, round	375P000003

Wire guides

▶ 100	Liner w/o insulation (x.40 m) for wire 1.0-1.2	322P2045_4*
100	Liner w/o insulation (x.40 m) for wire 1.4-1.6	322P2545_4*
101	Collet for liners dia. 4.5 mm	330P025045
110	Teflon liner red (x.50 m) for wire 1.0-1.2	326P2040_5*
110	Teflon liner yellow (x.50 m) for wire 1.2-1.6	326P2747_5*
111	Collet for teflon and PA liner 2.0x4.0 mm	331P020040
111	Collet for teflon and PA liner 2.7x4.7 mm	331P027047
112	O-ring 3.50x1.50 mm (teflon liner)	365P150035
113	Support tube 5x4.4 mm, L=150 mm	329P544150
120	PA-Alu wire guide (x.50 m) for wire 1.0-1.2	328P2040_A*
120	PA-Alu wire guide (x.50 m) for wire 1.2-1.6	328P2347_A*
120	PA-Alu wire guide (x.50 m) for wire 2.0-2.4	328P2947_A*