



Classic TBi 351

Watercooled

Robust and flexible water-power cable

Uses same consumables as TBi 250

Technical data

MIG/MAG (GMAW) Semi-automatic welding torch TBi 351

Rating at 100% ED
(10 min. cycle)

- Mixed gas: 280 A
- CO₂: 320 A

Cooling method Watercooling

Wire diameter 0.8 - 1.2 mm

Gas flow 14 l/min

Technical specification according to IEC 60974-7

Weight with 1.5m cabel 1.50 kg

Connection Euro-Central connector
Other connectors (e.g. Cloos®, ESAB®) available upon request.

Torch rating will be reduced when using pulsed-arc power sources.
Special torch necks and custom lengths of the cable assembly are available upon request.

Ordering Information

TBi 351 ESW, 50° bent 122P4415_0*

* At the blank, please insert 3, 4 or 5 for a torch length of 3, 4 or 5m.

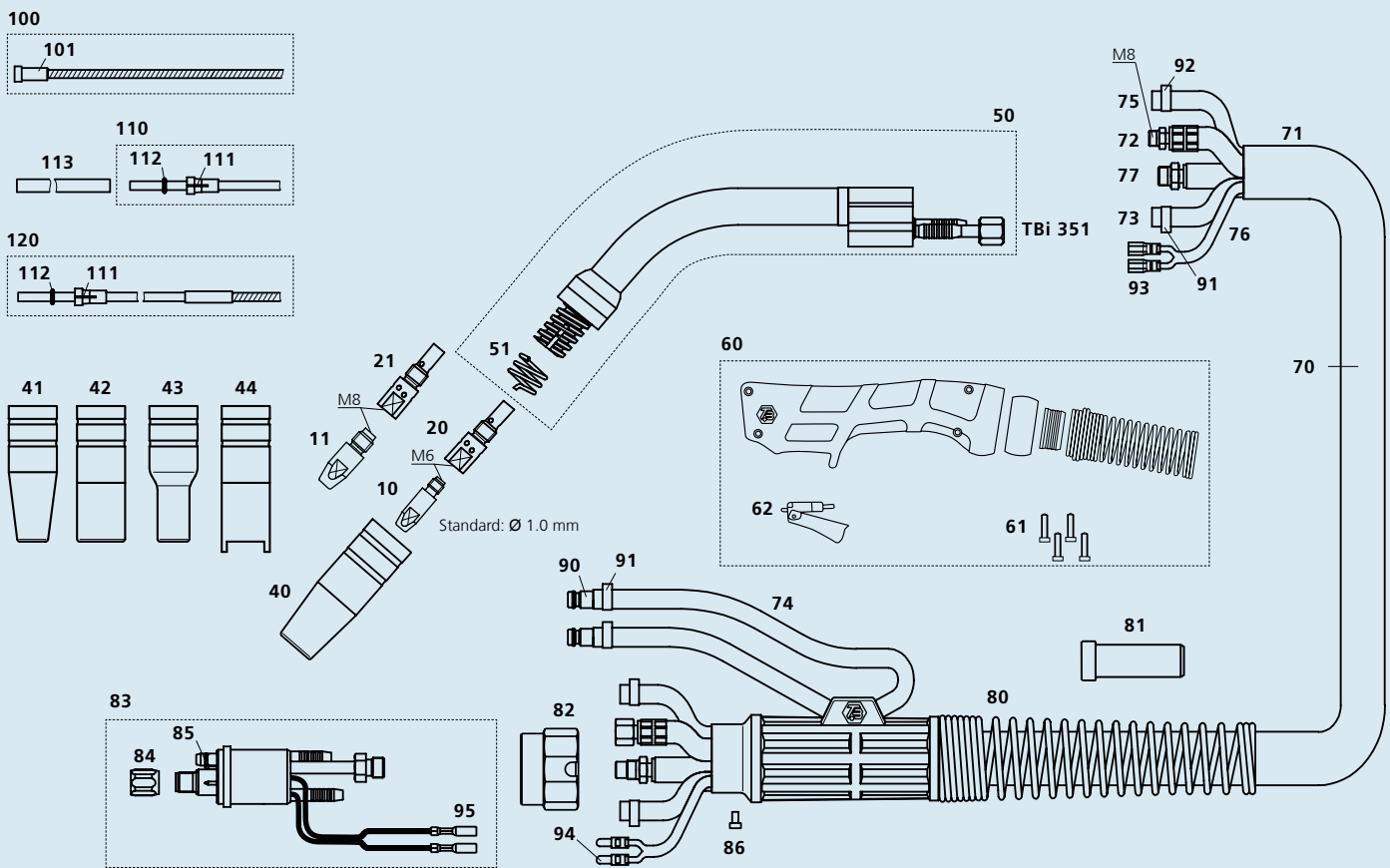

Pos.	Description	Part. No.	Pos.	Description	Part. No.
Contact tips					
▶ 10	Contact tip M6x28, Ecu	340P_1069*	75	PVC-Gas hose, black 4.5x1.5 mm	302P010000
10	Contact tip M6x28, CuCrZr	340P_3069*	76	Control cable x.30 m cpl.	301P2304_0*
10	Contact tip M6x28 Alu, Ecu	341P_1069*	77	Wire conduit yellow ‚Classic‘	356P0401_0*
11	Contact tip M8x30, Ecu	340P_1262*	80	Cable support 3 parts cpl. with spring	701P101071
11	Contact tip M8x30, CuCrZr	340P_3262*	81	Cable support 70 sqmm	600P002107
11	Contact tip M8x30 Alu, Ecu	341P_1262*	82	Adaptor nut	701P001013
Tip holders					
▶ 20	Tip holder M6 / L=35 mm	342P006003	83	Central adaptor ESW cpl., 2 poles, moveable pins	701P001049
21	Tip holder M8 / L=35 mm	342P008003	84	Sleeve nut M10x1	701P002005
Gas nozzles					
▶ 40	Nozzle con. diam. 15.0 mm	345P012003	85	O-ring 4.0x1.0 mm (gas nipple)	365P100040
41	Nozzle con. diam. 11.0 mm	345P013003	86	Slotted screw M4x6	100P008401
42	Nozzle cyl. diam. 20.0 mm	345P011003	90	Quick connector	701P002064
43	Nozzle bottle form diam. 14.0 mm	345P014003	91	Hose clamp Ø 9.5 with ring	373P100095
44	Spot weld nozzle diam. 18.0 mm long insul.	345P015503	92	Hose clamp Ø 8.7	371P000087
Spare parts					
50	Torch neck TBi 351, 50°	122P001001	93	Cable lug, flat	375P000023
51	Nozzle spring TBi 250/252/351	103P002006	94	Insulated connector, male, round	375P000004
60	Handle blue, watercooled, cpl. kit	380P220401	95	Insulated connector, female, round	375P000003
61	Cross recessed screw M 3.5x14	100P008413	Wire guides		
62	Trigger, red, 2 poles	385P021016	▶ 100	Liner w/o insulation (x.40 m) for wire 1.0-1.2	322P2045_4*
70	Cable assembly ‚Classic‘	122P4045_0*	100	Liner w/ insulation blue (x.40 m) for wire 0.8-1.0	324P1545_4*
71	Fabric outer cover 25x1.5 mm, cpl.	307P2528_A*	101	Collet for liners dia. 4.5 mm	330P025045
72	Water power cable ‚Classic‘	314P1621_0*	110	Teflon liner blue (x.50 m) for wire 0.6-0.9	326P1540_5*
73	PVC-Water hose, blue 5x1.5 mm	303P050000	110	Teflon liner red (x.50 m) for wire 1.0-1.2	326P2040_5*
74	PVC-Water hose, red 5x1.5 mm	303P060000	111	Collet for teflon and PA liner 2.0x4.0 mm	331P020040
			112	O-ring 3.50x1.50 mm (teflon liner)	365P150035
			113	Support tube 5x4.4 mm, L=150 mm	329P544150
			120	PA-Alu wire guide (x.50 m) for wire 1.0-1.2	328P2040_A*

▶ = Standard parts

* At the blank, please insert suitable information for torch length or wire diameter, e.g. 08 for 0.8 mm or 3 for 3 m.

© 2006 TBI Industries GmbH. All rights reserved. Subject to change without notice. Warranty only when using original TBI consumables and spare parts. Excerpts and reprints not permitted. Nr. DOKP111192, 03/2006.

TBI Industries GmbH
 Ruhberg 14
 D-35463 Fernwald-Steinbach
 P.O. Box 67
 D-35461 Fernwald-Steinbach

Tel. + 49 6404 9171-0
 Fax. + 49 6404 9171-40
 Internet: www.tbi-industries.com
 E-mail: info@tbi-industries.com